

Addressable CBS Emergency Light

Dimensional Drawings:

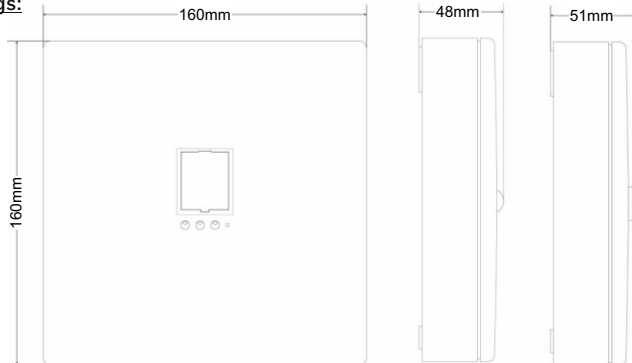

Installation:

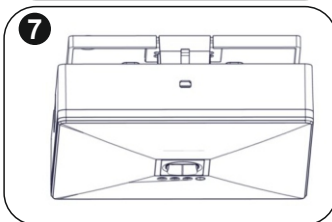
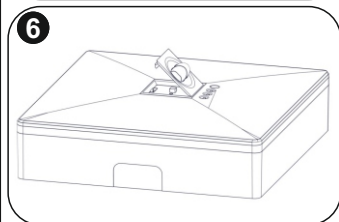
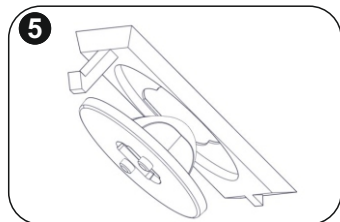
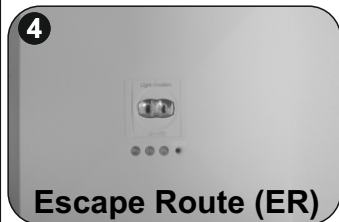
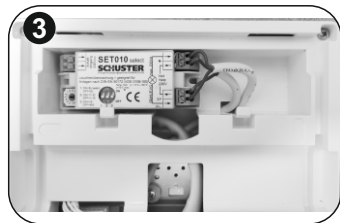
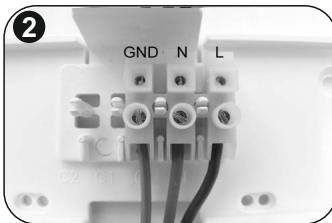
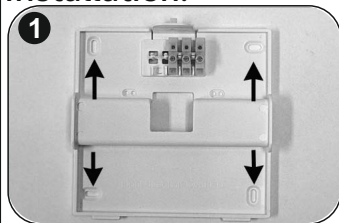

Disassembly: Press the plastic hook (picture 4) using e.g. a screwdriver and carefully pull the luminaire down.

Step 1: Mount the socket, make sure that the light direction is correct (marked in socket).

Step 2: Connect the mains cables L, N and GND (optional) to the terminal block. Power supply cables cross section should be 0.8 – 3 mm².

Step 3: Set the module address. For more information about module settings see the next page.

Step 4: In order to place the proper lens (Anti - panic or escape route), first be sure that the luminaire is not connected to the power supply. A 5 lux lens (Part no. 2900XX.STR) is also available for order. Use the corresponding lens retaining cover depending on the lens you will use.

Step 5: Put the lens on the retaining cover.

Step 6: Insert the cover with the lens on the luminaire. Be carefull not to touch the LED.

Step 7: Hook the luminaire to the two notches in the socket and push carefully until the plastic hook locks.

Technical description	Ova-OmniLED Square Surface ER/AP SET-10 230V
Part no.:	138006.S10
Operation Voltage:	100-240V AC/DC, 50-60 Hz
Maximum Power Consumption:	4.6W / 4.9VA
Lumen output:	360 lm
Produced in accordance with:	EN 60598-1, EN 60598-2-22, EN 55015 EN 61547, EN 61000-3-2, EN 61000-3-3
Ambient Temperature Range:	-10 to 60 °C
Relative Humidity:	Up to 95%
Degree of cover protection:	IP20
Technical lifetime (light source):	> 100000 hours
Weight:	450 gr



At the end of their useful life the packaging and product should be disposed of via a suitable recycling centre.
Do not dispose of with your normal household waste.
Do not burn.



The light source contained in this luminary shall only be replaced by the manufacturer, or his agent, or a similar qualified person.

NOTE! The light source is non-user replaceable.

SET010 select

MODULE FOR SINGLE LAMP SELECTION AND MONITORING

Switching of one selected light in the electric circuit

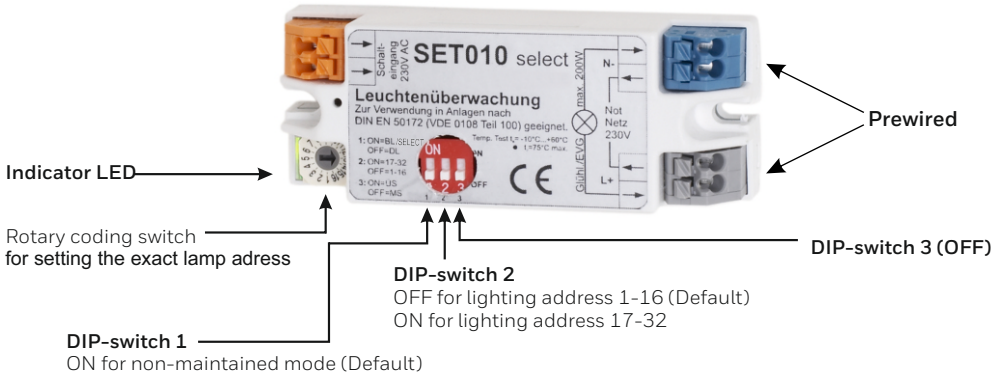

Attention!
Connect L and N correctly!
Exchanging L and N causes malfunction.

Function

By means of a suitable control, it is possible with the aid of the SET010 select to determine whether the lamp connected to it is ready for use or faulty.

Settings

Setting the lighting address is carried out by a rotary coding switch that is easily accessible from the outside.

Lighting addresses 1 to 16 can be selected when DIP switch 2 is set at OFF.

The module is already prepared for administering a total of 32 lighting addresses.

The address range 17 to 32 can be selected by setting DIP switch 2 to ON.

(DIP switch 2 = ON and rotary coding switch = 1 is equivalent to lighting address 17 etc.)

Technical description	SET010 select
Dimensions (L x W x H in mm)	78 x 30 x 20
Temperature:	-10°C up to +60°C, T_{cmax} = +75°C
Cross section:	Max: 1.5mm ²